

Knife gate valve RKO

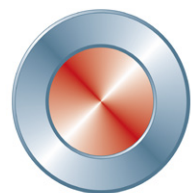
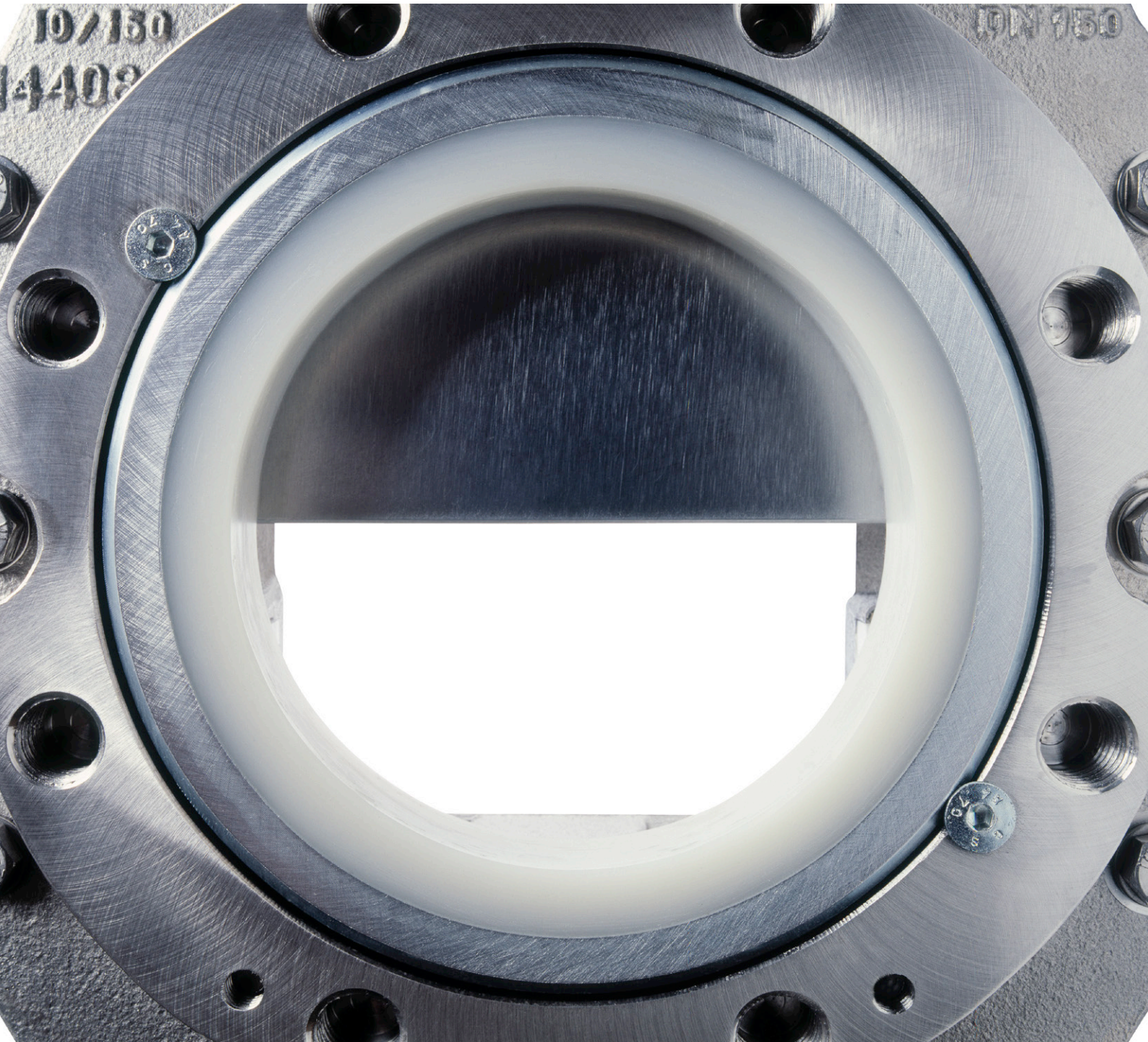

Stafsjö
SINCE 1666

Knife gate valve RKO

Stafsjö's knife gate valve RKO is reliable and particularly well suited for demanding reject and other abrasive media. The valve's circular inlet and square outlet together with the gate, that has a rectangular shape and a bevel edge, counteracts clogging and blockages, which often is a problem in combination with junk traps, coarse reject and cleaners. If needed, the valve can be supplied with an adaptor cone on the square side with weld connection or with flange connection.

RKO has a robust valve body with integrated purge ports, which is available in stainless steel or epoxy coated cast iron or nodular iron. As standard the valve comes with a hard chromed gate in Duplex stainless steel, exchangeable guide strips and the retainer ring system which makes maintenance simple and cost-efficient. RKO is supplied with a polyurethane seat or a retainer ring in stainless steel with a PTFE seat. The glandbox is supplied with Stafsjö's unique gland box packing, TwinPack™, to secure that no media reaches the surrounding environment. The valve can also be supplied with double gland for the most demanding applications.

The top work consists of aluminium beams and stainless steel tie rods, which gives good corrosion resistance and a stable operation. There are several actuator types and accessories to choose from in Stafsjö's standard collection.

The RKO valve is designed, manufactured, inspected and tested according to the European Pressure Equipment Directive (PED 97/23/EC) category I and II module A1. The valve is CE marked when it is applicable.

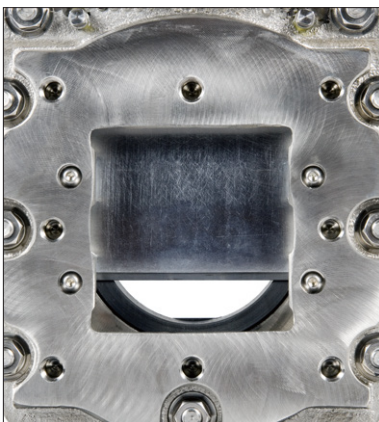

Proven design for abrasive and demanding applications

Upon closure the gate cut-off the media effectively and the bore design, with a circular inlet and a larger square outlet, assures a non-clogging shut-off.



Easy maintenance lowers the life cycle cost

The RKO can easily be maintained for extended service life. For example, Stafsjö's retainer ring that hold the seat in place is locked with screws just as the guide strips are, making the parts extremely easy to change if needed.



A solid top works assures stability and a preserved sealing

A stable operation and a proper dimensioned top work makes the shut-off reliable and repeatable. It also minimizes wear of the equipment.

Design data

| Sizes | Flange drilling | Face-to-face dimension | ATEX Design |
|-----------------|---|---|---|
| DN 100 - DN 600 | EN 1092 PN 10 JIS B 2238 10K ASME/ANSI B16.5 Class 150 AS Table D & E BS Table D | Stafsjö manufacturing standard TAPPI TIS 405-8 MSS SP-81 | ATEX 94/ 9/EC II cat 3 G/D for zone 2 and 22 on request |

Other sizes on request

| Leakage rate | Pressure tests |
|--|--|
| EN 12266-1:2012 rate A: No visually detectable leakage is allowed for duration of the test | Pressure tests are performed with water at 20° C according to EN 12266-1:2012. Pressure for shell test: 1,5 times maximum allowable working pressure for open valve. Pressure for seat tightness test: 1,1 times maximum allowable differential pressure for closed valve. |

| Maximum working pressure body at 20°C | | Maximum differential pressure in preferred direction at 20°C | |
|---------------------------------------|-----|--|-----|
| DN | bar | DN | bar |
| 100 - 450 | 10 | 100 - 450 | 6,2 |
| 500 - 600 | 6 | 500 - 600 | 4 |

Basic equipment

| A. Valve Body | | | | |
|---------------|-----------------|------|----------------|------------------------|
| DN | Material | Code | Type | Maximum temperature °C |
| 100 - 600 | Stainless steel | (E) | EN 1.4408 | 400 |
| 100 - 400 | Cast iron | (A) | EN-JL1030/GG20 | 150 |
| 500 - 600 | Carbon steel | (C) | WCC/ASTM A216 | 425 |

Standard colour for valve body in cast iron or carbon steel: epoxy, RAL 5015, thickness 140-200 µm.

| B. Gate | | |
|------------------------|-----------------------------|----------------------|
| Material | Type | Surface treatment |
| Duplex stainless steel | EN 1.4462/AISI 2205/SS 2377 | Hard chromed surface |

| C. Retainer ring | |
|-------------------------------|----------------|
| Material | Type |
| Stainless steel ²⁾ | EN 1.4408 |
| Cast iron ³⁾ | EN-JL1030/GG20 |

²⁾ Standard on RKO-E.

³⁾ Standard on RKO-A. Standard colour for retainer ring in cast iron: epoxy colour, thickness 140-200µm, RAL 5015.

| D. Seat | | |
|--------------------------|------|------------------------|
| Material | Code | Maximum temperature °C |
| PTFE with o-ring Nitrile | (P) | 100 |
| PTFE with o-ring Viton | (PV) | 180 |
| Polyurethane | (U) | 90 |

| E. Box packing | | |
|----------------|------|------------------------|
| Material | Code | Maximum temperature °C |
| TwinPack™ | (TY) | 260 |
| PTFE | (TF) | 280 |
| Garlock 127 | (TG) | 650 |

Actuators

| Manual | Code | Automatic | Code |
|---------------------------|------|----------------------------------|------|
| Hand wheel ⁴⁾ | (HW) | Pneumatic cylinder | (EC) |
| Chain wheel ⁵⁾ | (CW) | Electrical motor | (EM) |
| | | Hydraulic cylinder ⁵⁾ | (MH) |

⁴⁾ For recommended size, see page 5 column E.

⁵⁾ For recommended size, see separate data sheet.

| Pneumatic cylinder | | | Electric motor – AUMA multi-turn | | |
|--------------------|---------|--------------------|----------------------------------|---------|------------|
| DN valve | Size EC | Maximum Force (kN) | DN valve | AUMA | Attachment |
| 100 | EC 100 | 3,5 | 100 | SA 07.2 | F10/A |
| 150 - 200 | EC 160 | 9,0 | 150 - 250 | SA 07.2 | F10/A |
| 250 - 350 | EC 200 | 14,1 | 300 - 450 | SA 10.2 | F10/A |
| 400 - 500 | EC 250 | 22,1 | 500 - 600 | SA 14.2 | F14/A |
| 600 | EC 320 | 36,2 | | | |

The table above gives recommended cylinder sizes at normal operation with 5 bar air pressure. For other operating conditions, please contact Stafsjö or your local representative for advice.

Electric motors are mounted according to standard ISO 5210. The table above gives recommended motor sizes at normal operation. For other operating conditions, please contact Stafsjö or your local representative for advice.

The actuators are described in detail in separate data sheets. For actuators classified according to ATEX, please contact Stafsjö or your local representative.

Options and accessories

| Knife gate valve | | | |
|-------------------------|------------|---|---|
| Accessories | Code | Model | Design |
| Mechanical limit switch | (MLS) | Omron D4V | 12-250 V AC/12-125 V DC, IP 65 |
| Inductive limit switch | (ILS) | ifm electronic IG0006 | 2-wire, 20-250 V AC/DC, IP 67 |
| | | ifm electronic IG5401 | 3-wire, 10-36 V DC PNP, IP 67 |
| Purge ports | (PP) | The valve has purge ports as standard | Pipe thread according to ISO 7/1: DN 100 Rp1/8", DN 150 - DN 250 Rp1/4", DN 300 - DN 600 Rp1/2" |
| Double gland | (DG) | Available for sizes DN 100-DN 400 | Stainless steel (1.4408) |
| Adapter cone | (AC-WC/FC) | See page 9 for further info | Stainless steel (1.4436/SS2343) |
| Pneumatic cylinder | | | |
| Accessories | Code | Model | Design |
| Solenoid valve | (SV) | Parker Namur valves for EC 100 - EC 160 | G1/4", Mono stable 5/2, Namur series VDI/VDE 3845, IP 65, 24 V DC/110 V AC/220 V AC |
| | | Parker Namur valves for EC 200 - EC 320 | G1/2", Mono stable 5/2, Namur series VDI/VDE 3845, IP 65, 24 V DC/110 V AC/220 V AC |
| Magnetic limit switch | (MagLS) | KITA KT50-R for EC 100 - EC 320 | 2-wire, 5-240 V AC/DC, IP 65 |
| | | KITA KT50-N for EC 100 - EC 320 | 3-wire, 10-30 V DC PNP, IP 65 |

The accessories are described in separate data sheets. For advice and information on other accessories or on ATEX-classified ones, please contact Stafsjö or your local representative.

Specify the Stafsjö valve

Stafsjö's valves are modular designed and they can easily be customized with gate, seat and box packings according to media and requirements, as well for actuators and accessories. Below are examples of how you can specify your Stafsjö valve. Further information is available on www.stafsjo.com.

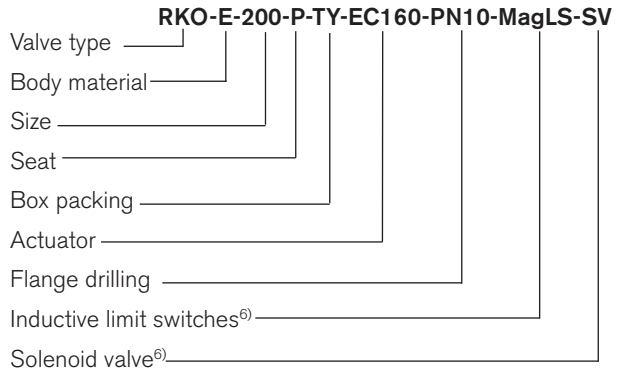
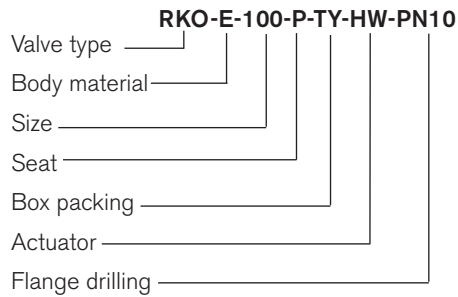

⁶⁾All electronics must be specified in detail.

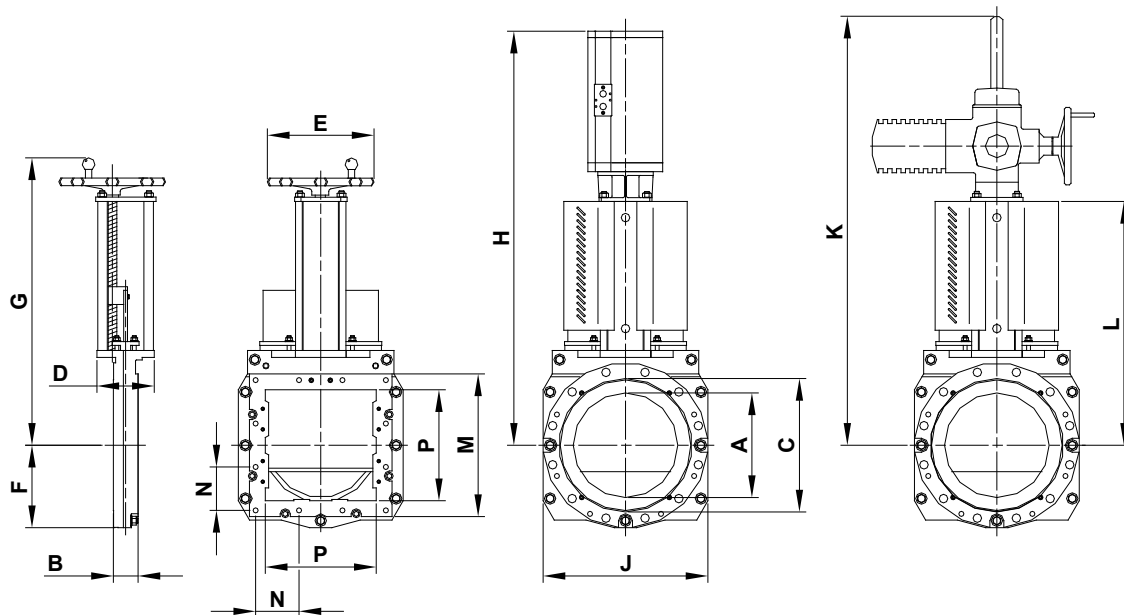

Main dimensions

| Dimension (mm) | | | | | | | | | | | | | | |
|----------------|-----|-----|-----|-----|-----|-----|------|------|-----|------|------|-----|-----|-------------------|
| DN | A | B | C | D | E | F | G | H | J | K | L | M | P | kg ⁷⁾ |
| 100 | 97 | 52 | 153 | 80 | 200 | 112 | 446 | 555 | 224 | 649 | 317 | 180 | 100 | 18 |
| 150 | 146 | 60 | 204 | 150 | 315 | 148 | 554 | 783 | 296 | 749 | 417 | 230 | 150 | 25 |
| 200 | 194 | 60 | 267 | 150 | 315 | 175 | 647 | 876 | 350 | 790 | 510 | 280 | 200 | 45 |
| 250 | 247 | 69 | 319 | 150 | 315 | 206 | 752 | 1135 | 412 | 878 | 598 | 340 | 250 | 60 |
| 300 | 298 | 78 | 374 | 180 | 400 | 232 | 867 | 1252 | 464 | 1026 | 715 | 400 | 300 | 80 |
| 350 | 330 | 78 | 419 | 180 | 400 | 260 | 921 | 1436 | 520 | 1080 | 769 | 450 | 350 | 90 |
| 400 | 380 | 89 | 480 | 206 | 520 | 287 | 1069 | 1506 | 574 | 1177 | 862 | 500 | 400 | 140 |
| 450 | 428 | 89 | 535 | 208 | 520 | 315 | 1130 | 1684 | 629 | 1450 | 940 | 555 | 483 | 300 |
| 500 | 500 | 96 | 586 | 320 | - | 355 | - | 1973 | 710 | - | 1099 | 656 | 519 | 330 ⁸⁾ |
| 600 | 600 | 100 | 685 | 306 | - | 396 | - | 2180 | 792 | - | 1226 | 742 | 614 | 400 ⁹⁾ |

⁷⁾ Weight of valve including hand wheel (HW). ⁸⁾ Weight of valve including EC 250. ⁹⁾ Weight valve including EC 320
Main dimensions are only for information. Contact Stafsjö for certified drawings.

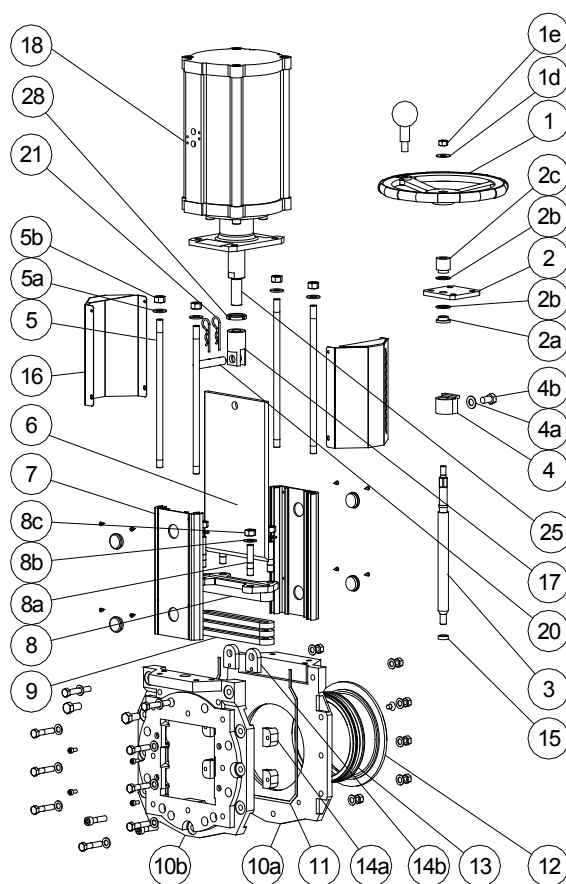

Part List

| Pos. | Part | Material (Name) |
|--------------------|---------------------------|---|
| 1 | Hand wheel | Epoxy coated cast iron Ø 200 - Ø 315 (EN-JL1040/GG25), ≥ Ø 400 (EN-JL1030/GG20) |
| 2 | Yoke | Stainless steel (EN 1.4301/SS 2333) |
| 2a | Bearing | Brass (CuZn39Pb3/SS 5170) |
| 2b | Slide washer | POM |
| 2c | Bearing | Brass (CuZn39Pb3/SS 5170) |
| 3 | Stem | Stainless steel (EN 1.4305/SS 2346) ≥ DN 300 (EN 1.4104/SS 2383) |
| 4 | Stem nut | Brass (CuZn39Pb3/SS 5170) |
| 4a | Washer | Stainless steel (A2) |
| 4b | Screw | Stainless steel (A2) |
| 5 | Tie rod | Stainless steel (EN 1.4301/SS 2333) |
| 5a | Washer | Stainless steel (A2) |
| 5b | Nut | Stainless steel (A2) |
| 6 | Gate | See equipment B |
| 7 | Beam | Aluminium (EN AW-6063-T6) |
| 8 | Gland | Stainless steel (EN 1.4408/SS 2343) |
| 8a | Stud bolt | Stainless steel (A2), zinc coated |
| 8b | Washer | Stainless steel (A2) |
| 8c | Nut | Stainless steel (A2), zinc coated |
| 9 | Box packing | See equipment E |
| 9 ¹⁰⁾ | Box packing | See equipment E |
| 10a | Valve body | See equipment A |
| 10b | Valve body | See equipment A |
| 11 | Body gasket | Grafoil ≥ DN 300 PTFE |
| 12 | Retainer ring | See equipment C |
| 13 | Seat | See equipment D |
| 13 ¹⁰⁾ | Seat | See equipment D |
| 14a ¹⁰⁾ | Guide strip | POM |
| 14b ¹⁰⁾ | Top guide strip | ≥ DN 300 POM |
| 15 | Bushing | Oil-bronze |
| 16 | Gate guard, not for HW | Stainless steel (EN 1.4301/SS 2333) |
| 17 | Gate clevis | Stainless steel (EN 1.4305/SS 2346) |
| 18 | Cylinder | See data sheet |
| 20 | Clevis pin | Stainless steel (EN 1.4305/SS 2346) |
| 21 | Split pin | Stainless steel (EN 1.4436/SS2343) |
| 25 | Piston rod | Stainless steel (EN 1.4305/SS 2346) |
| 28 | Locking nut | Stainless steel (EN 1.4305/SS 2346) |

| Pos. | Part | Material (Name) |
|--------------------|---------------------------|-------------------------------------|
| 8c | Nut | Stainless steel (A2), zinc coated |
| 9 ¹⁰⁾ | Box packing | See equipment E |
| 10a | Valve body | See equipment A |
| 10b | Valve body | See equipment A |
| 11 | Body gasket | Grafoil ≥ DN 300 PTFE |
| 12 | Retainer ring | See equipment C |
| 13 ¹⁰⁾ | Seat | See equipment D |
| 14a ¹⁰⁾ | Guide strip | POM |
| 14b ¹⁰⁾ | Top guide strip | ≥ DN 300 POM |
| 15 | Bushing | Oil-bronze |
| 16 | Gate guard, not for HW | Stainless steel (EN 1.4301/SS 2333) |
| 17 | Gate clevis | Stainless steel (EN 1.4305/SS 2346) |
| 18 | Cylinder | See data sheet |
| 20 | Clevis pin | Stainless steel (EN 1.4305/SS 2346) |
| 21 | Split pin | Stainless steel (EN 1.4436/SS2343) |
| 25 | Piston rod | Stainless steel (EN 1.4305/SS 2346) |
| 28 | Locking nut | Stainless steel (EN 1.4305/SS 2346) |

¹⁰⁾ Recommended spare parts

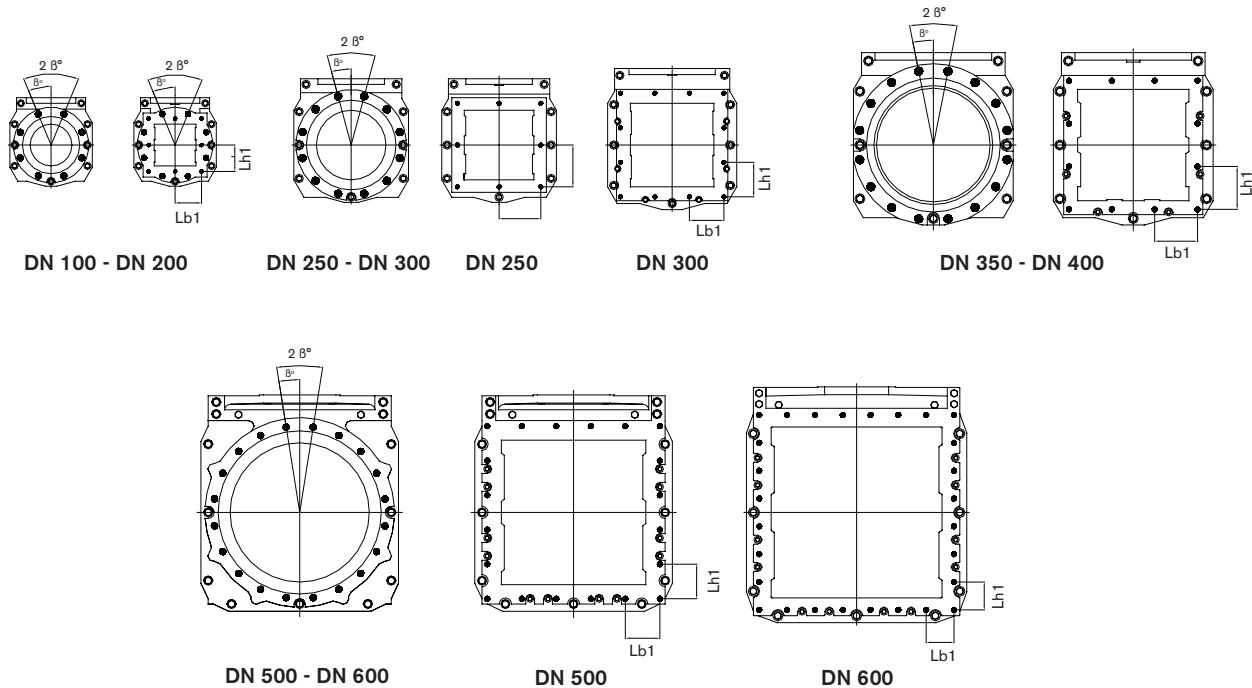

Flange drilling

Circular inlet: EN 1092 PN10 (mm)

| DN | 100 | 150 | 200 | 250 | 300 | 350 | 400 | 450 | 500 | 600 |
|-----------------------------|-----|-----|-----|-----|-----|------|------|-----|-----|-----|
| Outside flange diameter | 220 | 285 | 340 | 395 | 445 | 505 | 565 | 615 | 670 | 780 |
| Bolt circle diameter | 180 | 240 | 295 | 350 | 400 | 460 | 515 | 565 | 620 | 725 |
| Number of tapped holes (•) | 8 | 8 | 8 | 12 | 12 | 16 | 16 | 20 | 20 | 20 |
| Bolt size | M16 | M20 | M20 | M20 | M20 | M20 | M24 | M24 | M24 | M27 |
| β° | 45 | 45 | 45 | 30 | 30 | 22,5 | 22,5 | 18 | 9 | 9 |
| Screw lengths ¹⁾ | 15 | 15 | 15 | 18 | 22 | 20 | 25 | 25 | 33 | 36 |

Square outlet: Stafsjö manufacturing standard or EN 1092 PN10 for DN 100 - DN 200 (mm)

| DN | 100 | 150 | 200 | 250 | 300 | 350 | 400 | 450 | 500 | 600 |
|-----------------------------|-----------------------|-----------------------|-----------------------|-----|-----|-----|-----|-----|-----|-----|
| Bolt circle diameter | 180 ²⁾ | 240 ²⁾ | 295 ²⁾ | - | - | - | - | - | - | - |
| Number of tapped holes (•) | 8 | 8 | 8 | 8 | 12 | 12 | 12 | 12 | 20 | 28 |
| Lb1 and Lh1 | 70 | 95 | 122,5 | 150 | 124 | 137 | 154 | 174 | 124 | 100 |
| Bolt size | M12/M16 ²⁾ | M12/M20 ²⁾ | M12/M20 ²⁾ | M12 | M12 | M16 | M16 | M16 | M16 | M16 |
| Screw lengths ¹⁾ | 15 | 15 | 15 | 20 | 23 | 23 | 28 | 24 | 20 | 20 |

¹⁾ Add the values with the thickness of pipe flanges, washers and gaskets.

²⁾ Body side with square outlet for sizes DN 100 - DN 200 can be drilled according to EN 1092 PN10.

• Tapped holes

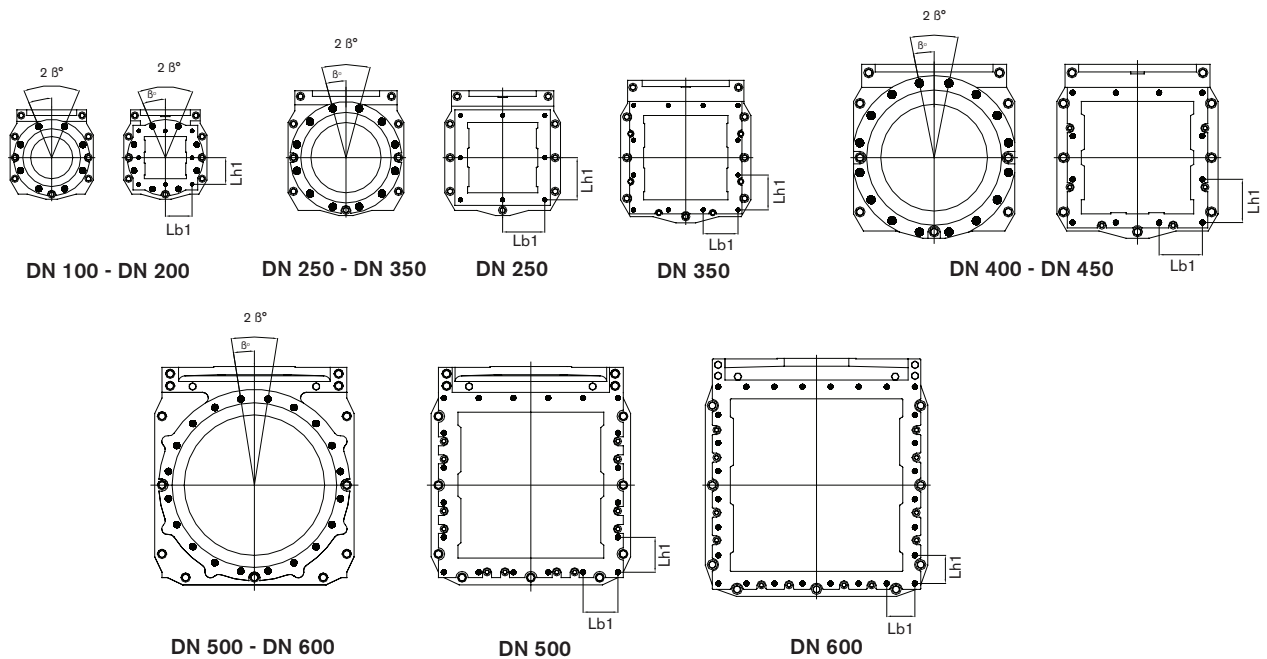

Flange drilling

Circular inlet: ASME/ANSI B16.5 Class 150 (mm)

| DN | 100 | 150 | 200 | 250 | 300 | 350 | 400 | 450 | 500 | 600 |
|-----------------------------|--------|--------|--------|-------|-------|-------|-------|---------|---------|---------|
| Outside flange diameter | 228,6 | 279,4 | 342,9 | 406,4 | 482,6 | 533 | 597 | 635 | 699 | 813 |
| Bolt circle diameter | 190,5 | 241,3 | 298,5 | 362 | 431,8 | 476,3 | 539,8 | 578 | 635 | 749 |
| Number of tapped holes (•) | 8 | 8 | 8 | 12 | 12 | 12 | 16 | 16 | 20 | 20 |
| Bolt size (UNC) | 5/8-11 | 3/4-10 | 3/4-10 | 7/8-9 | 7/8-9 | 1-8 | 1-8 | 11/8"-7 | 11/8"-7 | 11/4"-7 |
| β° | 45 | 45 | 45 | 30 | 30 | 30 | 22,5 | 11,25 | 9 | 9 |
| Screw lengths ¹⁾ | 15 | 15 | 15 | 18 | 22 | 20 | 18 | 23 | 33 | 36 |

Square outlet: Stafsjö manufacturing standard or ANSI B16.5 Class 150 for DN 100 - DN 200 (mm)

| DN | 100 | 150 | 200 | 250 | 300 | 350 | 400 | 450 | 500 | 600 |
|-----------------------------|--|--|--|--------|--------|--------|--------|--------|--------|--------|
| Bolt circle diameter | 190,5 ²⁾ | 241,3 ²⁾ | 298,5 ²⁾ | - | - | - | - | - | - | - |
| Number of tapped holes (•) | 8 | 8 | 8 | 8 | 12 | 12 | 12 | 12 | 20 | 28 |
| Lb1 and Lh1 | 70 | 95 | 122,5 | 150 | 124 | 137 | 154 | 174 | 124 | 100 |
| Bolt size (UNC) | 1/2-13 alt. 5/8-11 ²⁾ | 1/2-13 alt. 3/4-10 ²⁾ | 1/2-13 alt. 3/4-10 ²⁾ | 1/2-13 | 1/2-13 | 5/8-11 | 5/8-11 | 5/8-11 | 5/8-11 | 5/8-11 |
| Screw lengths ¹⁾ | 15 | 15 | 15 | 20 | 23 | 23 | 28 | 24 | 20 | 20 |

¹⁾ Add the values with the thickness of pipe flanges, washers and gaskets.

²⁾ Body side with square outlet for sizes DN 100 - DN 200 can be drilled according to ANSI B16.5 Class 150.

• Tapped holes

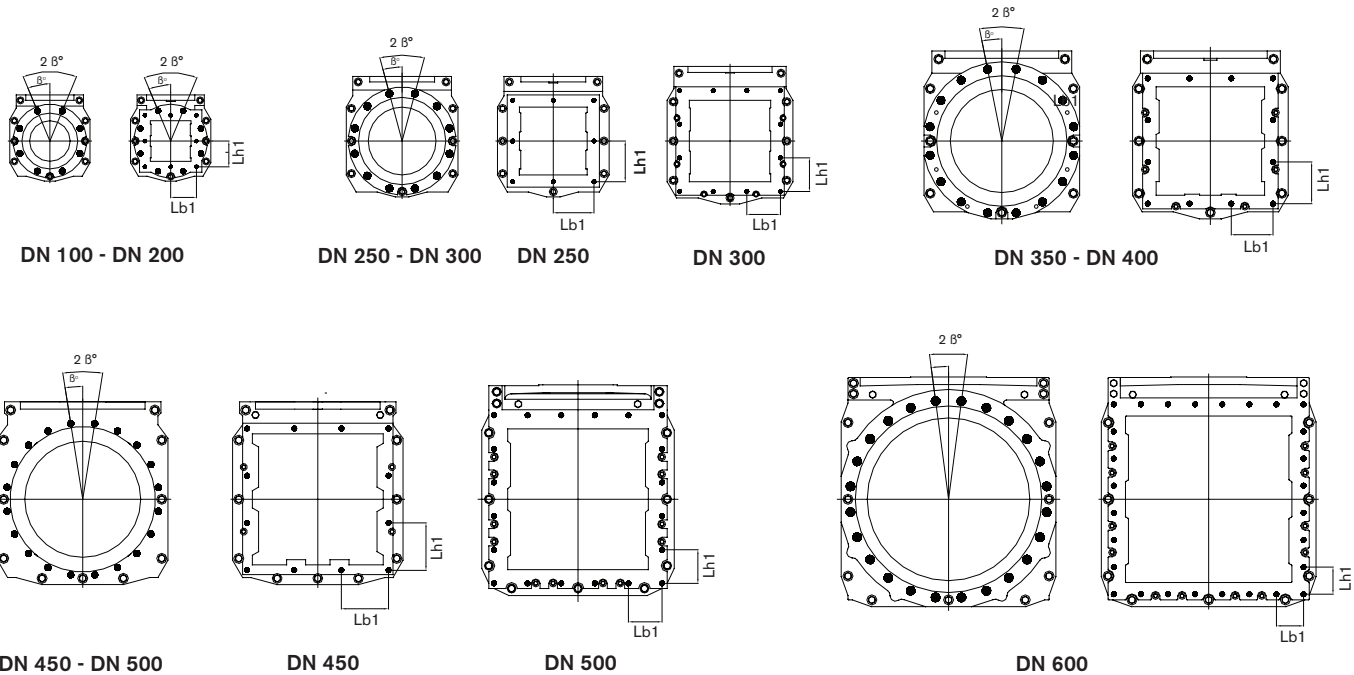

Flange drilling

| Circular inlet: JIS B 2238 10K (mm) | | | | | | | | | | |
|-------------------------------------|------|------|-----|-----|-----|-------|-------|-----|-----|-----|
| DN | 100 | 150 | 200 | 250 | 300 | 350 | 400 | 450 | 500 | 600 |
| Outside flange diameter | 210 | 280 | 330 | 400 | 445 | 490 | 550 | 620 | 675 | 795 |
| Bolt circle diameter | 175 | 240 | 290 | 355 | 400 | 455 | 510 | 565 | 620 | 730 |
| Number of tapped holes (•) | 8 | 8 | 12 | 12 | 12 | 16 | 16 | 20 | 20 | 24 |
| Bolt size | M16 | M20 | M20 | M22 | M22 | M22 | M24 | M24 | M24 | M30 |
| β° | 22,5 | 22,5 | 15 | 15 | 15 | 11,25 | 11,25 | 9 | 9 | 7,5 |
| Screw lengths ¹⁾ | 15 | 15 | 15 | 18 | 22 | 20 | 18 | 23 | 33 | 36 |

| Square outlet: Stafsjö manufacturing standard or JIS B 2238 10K for DN 100 - DN 200 (mm) | | | | | | | | | | |
|--|-----------------------|-----------------------|-------------------|-----|-----|-----|-----|-----|-----|-----|
| DN | 100 | 150 | 200 | 250 | 300 | 350 | 400 | 450 | 500 | 600 |
| Bolt circle diameter | 175 ²⁾ | 240 ²⁾ | 290 ²⁾ | - | - | - | - | - | - | - |
| Number of tapped holes (•) | 8 | 8 | 8 | 8 | 12 | 12 | 12 | 12 | 20 | 28 |
| Lb1 and Lh1 | 70 | 95 | 122,5 | 150 | 124 | 137 | 154 | 174 | 124 | 100 |
| Bolt size | M12/M16 ²⁾ | M12/M20 ²⁾ | M12 | M12 | M12 | M16 | M16 | M16 | M16 | M16 |
| Screw lengths ¹⁾ | 15 | 15 | 15 | 20 | 23 | 23 | 28 | 24 | 20 | 20 |

¹⁾ Add the values with the thickness of pipe flanges, washers and gaskets.

²⁾ Body side with square outlet for sizes DN 100 - DN 150 can be drilled according to JIS B 2238 10K

• Tapped holes

Adapter cone for RKO

RKO can be equipped with an adapter cone on the square side (outlet). There are two types of adapters; one for flange connection and one for welding connection. Adapter cone for DN 500 & DN 600 can be supplied on request. Material: Stainless steel (EN 1.4436/SS2343).

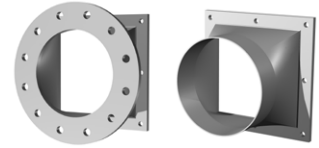

Main dimensions

| DN | L | M | N | N ₁ | ØH ₁ | Ant | L _{K1} | L _{K2} |
|-----|-----|-----|-------|----------------|-----------------|-----|-----------------|-----------------|
| 100 | 100 | 180 | 70 | 70 | 14 | 8 | 90 | 150 |
| 150 | 150 | 230 | 95 | 95 | 14 | 8 | 140 | 200 |
| 200 | 200 | 280 | 122,5 | 122,5 | 14 | 8 | 140 | 200 |
| 250 | 250 | 340 | 150 | 150 | 14 | 8 | 150 | 210 |
| 300 | 300 | 400 | 124 | 186 | 14 | 12 | 167 | 245 |
| 350 | 350 | 450 | 137 | 205,5 | 18 | 12 | 165 | 243 |
| 400 | 400 | 500 | 154 | 231 | 18 | 12 | 155 | 244 |
| 450 | 483 | 555 | 174 | 261 | 18 | 12 | 155 | 244 |
| 500 | 558 | 658 | 124 | 310 | 18 | 20 | 190 | 286 |

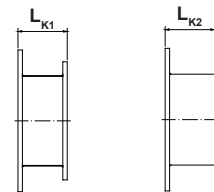
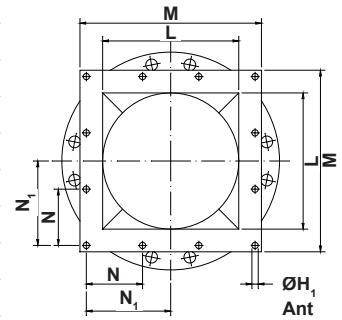

Flange drilling

EN 1092 PN10 (mm)

| DN | 100 | 150 | 200 | 250 | 300 | 350 | 400 | 450 | 500 |
|------------------------------|------|------|------|-----|-----|-------|-------|-----|-----|
| Outside flange diameter | 224 | 280 | 340 | 405 | 480 | 530 | 565 | 615 | 705 |
| Bolt circle diameter | 180 | 240 | 295 | 350 | 400 | 460 | 515 | 565 | 620 |
| Number of throughgoing holes | 8 | 8 | 8 | 12 | 12 | 16 | 16 | 20 | 20 |
| Hole size | 18 | 22 | 22 | 22 | 22 | 22 | 26 | 26 | 26 |
| β° | 22,5 | 22,5 | 22,5 | 15 | 15 | 11,25 | 11,25 | 9 | 9 |

JIS B 2238 10K (mm)

| DN | 100 | 150 | 200 | 250 | 300 | 350 | 400 | 450 | 500 |
|------------------------------|------|------|-----|-----|-------|-------|-------|-----|-----|
| Outside flange diameter | 224 | 280 | 340 | 405 | 480 | 530 | 550 | 620 | 705 |
| Bolt circle diameter | 175 | 240 | 290 | 355 | 400 | 445 | 510 | 565 | 620 |
| Number of throughgoing holes | 8 | 8 | 12 | 12 | 16 | 16 | 16 | 20 | 20 |
| Hole size | 19 | 23 | 23 | 25 | 25 | 22 | 27 | 27 | 27 |
| β° | 22,5 | 22,5 | 15 | 15 | 11,25 | 11,25 | 11,25 | 9 | 9 |

ANSI B16.5 Class 150 (mm)

| DN | 100 | 150 | 200 | 250 | 300 | 350 | 400 | 450 | 500 |
|------------------------------|-------|-------|-------|-------|-------|-----|-------|-------|-----|
| Outside flange diameter | 224 | 280 | 340 | 405 | 480 | 530 | 597 | 635 | 705 |
| Bolt circle diameter | 190,5 | 241,3 | 298,4 | 361,9 | 431,8 | 476 | 540 | 578 | 635 |
| Number of throughgoing holes | 8 | 8 | 8 | 12 | 12 | 12 | 16 | 16 | 20 |
| Hole size | 18 | 22 | 22 | 26 | 26 | 30 | 30 | 33 | 33 |
| β° | 22,5 | 22,5 | 22,5 | 15 | 15 | 15 | 11,25 | 11,25 | 9 |

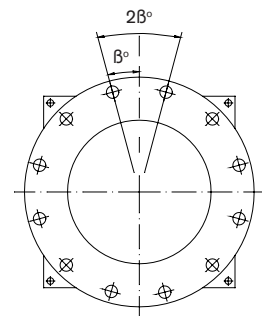

Further information is available on www.stafsjo.com

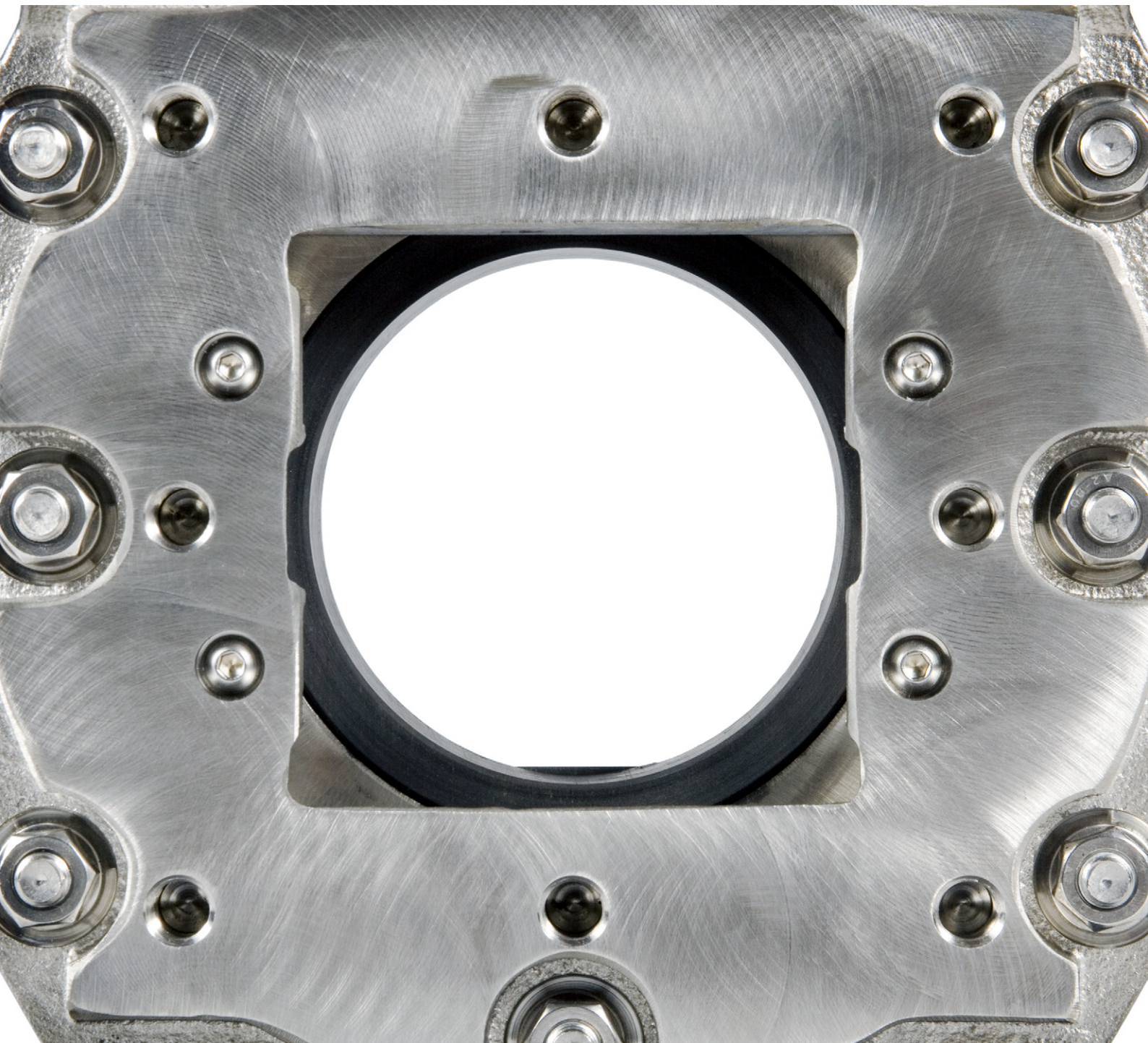

Globally active. Locally represented.

AFRICA South Africa: Valve & Automation (Pty) Ltd, ASIA China: EBRO ARMATUREN (BEIJING) CO., LTD, India: Ebro Armaturen India Pvt. Ltd, Indonesia: Contromatic Prima Mandiri PT, Japan: SKC Co. Ltd, Malaysia: Precision Control SdnBnd, Philippines: EBRO ARMATUREN (PHILIPPINES) INC., Thailand: EBRO VALVES (Trading) Co. Ltd, Vietnam: EBRO VALVES (Thailand) Co., Ltd, AUSTRALIA WITH OCEANIA Australia: EBRO ARMATUREN Pacific PTY. LTD, New Zealand: H.J.Asmuss&Co.Ltd, EUROPE Austria: EBRO ARMATUREN GmbH, Belgium: V.C.T. - Valve & Connector Technology n.v., Denmark: Valtor Industri A/S, Finland: Tecalemit Flow Oy, France: EBRO ARMATUREN and GL&V, Germany: EBRO ARMATUREN Gebr. Bröer GmbH, Great Britain: EBRO Valves Ltd, Hungary: EBRO ARMATUREN Kft, Ireland: Induchem Components Ltd, Iceland: Hédinn HF, Italy: EBRO VALVOLE SRL, The Netherlands: EBRO VALVES B.V., Norway: BAGGES AS, Poland: EBRO ARMATUREN GmbH, Portugal: AxFlow Comércio de Equipamentos LDA, RUSSIA/BELARUS/UKRAINE: EBRO ARMATUREN and LesBumMash Ltd, Spain: EBRO ARMATUREN ESPAÑA, S.L., Switzerland: EBRO Armaturen Est. & Co. KG, Sweden: Stafsjö Valves AB and Ahlsell, Turkey: EBRO ARMATUREN Otomasyon Sistemleri San ve Tic Ltd. Sti NORTH & SOUTH AMERICA Argentina: ESCO ARGENTINA S.A, Brazil: Ebro Stafsjö Valves do Brasil LTD, Canada: Armour Valve Ltd, Chile: Ebro Stafsjö Valves Chile Ltd, USA: EBRO ARMATUREN USA Inc., For other countries, please contact us directly.

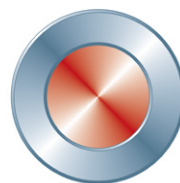

Stafsjö
SINCE 1666